



Front yard or Junkyard?

Christine Loh

Current Perceptions

“It’s an old friend from childhood. It’s calm and reassuring simply being there”. Retiree

“Victoria Harbour is my closest friend; he knows all my deepest secrets and he supports me during hard times.... He knows me better than my parents.” Teen

“A place where I can be myself, relax and be with my friends.... You have the time and space all to yourselves. No pressure.” Teen

“It is not just a backdrop.... It reminds me of the hard work we have to put in to be successful. It’s like a beacon.”

Older White Collar

“I want my kids to witness and experience the changes of Hong Kong via the Harbour not just from text book.” Older White Collar

Perception of The Harbour in the Future

“Further reclamation and drastic changes of the Harbour is literally taking part of my memory away.”

Retiree

“It’s like there is an invisible wall to hinder me from getting close to the Harbour.”

Older White Collar

“Bring out the natural nature of the Harbour. Lying on the grass, picnicking would be such a treat.”

Older White Collar

“Venice-like type of place – so that you could have a relaxing afternoon tea.”

Younger White Collar

“I long for a place in Hong Kong that is fit for leisure strolling.”

Younger Blue Collar

Highway paradise



高架行人之路
(自橋樑開始)
ELEVATED WALKWAY
SUBJECT TO
DETAILED DESIGN

電影及有關設施
CINEMA AND ASSOCIATED FACILITIES

再開發有關之商業及休閒用途
WATERFRONT RELATED
COMMERCIAL AND LEISURE USES

單車徑 (自橋樑開始)
BICYCLE PATH
SUBJECT TO DETAILED DESIGN

可變性用途 (如有興趣)
CONTACT US
CONTACT TO OBTAIN DETAILED DRAWING

再開發有關之商業及休閒用途
WATERFRONT RELATED
COMMERCIAL AND LEISURE USES

海濱公園
MARINE PARK

港口 (自橋樑開始)
ROAD JUNCTION
SUBJECT TO DETAILED DESIGN

高架行人之路
(自橋樑開始)
ELEVATED WALKWAY
SUBJECT TO
DETAILED DESIGN

高架行人之路
(自橋樑開始)
ELEVATED WALKWAY
SUBJECT TO
DETAILED DESIGN

高架行人之路
(自橋樑開始)
ELEVATED WALKWAY
SUBJECT TO DETAILED DESIGN

海濱公園、劇院、咖啡館、酒吧、
遊樂及有關設施
PROMENADE WITH PIER LANDING AREA
AND UNDERGROUND PUBHOUSE
AND ASSOCIATED STRUCTURES

正義道
JUSTICE DRIVE
EXTENSION



HARBOURFRONT OF 1000 YEARS

一千年



HARBOURFRONT OF 1000 YEARS

一七



Government plans

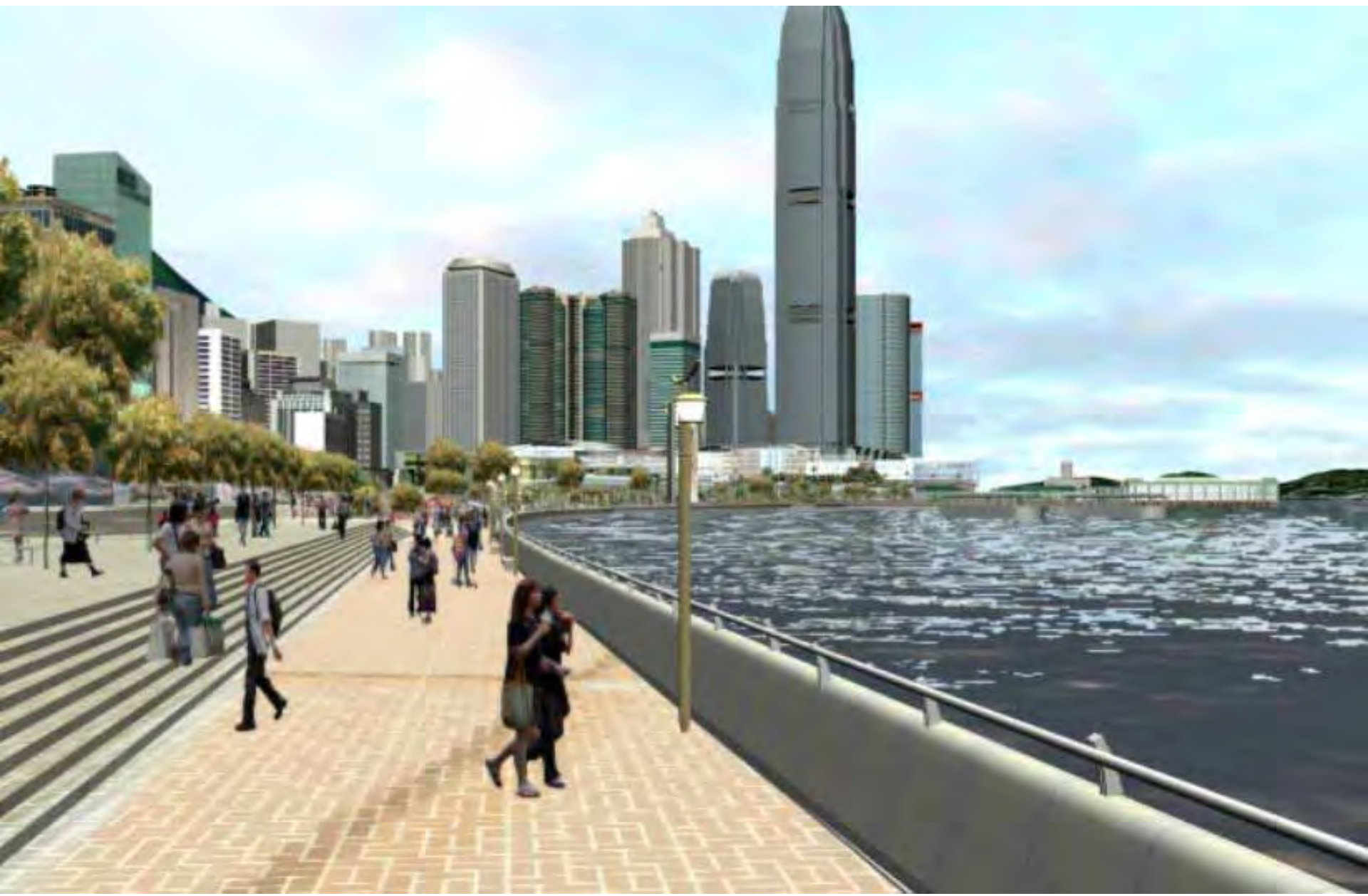

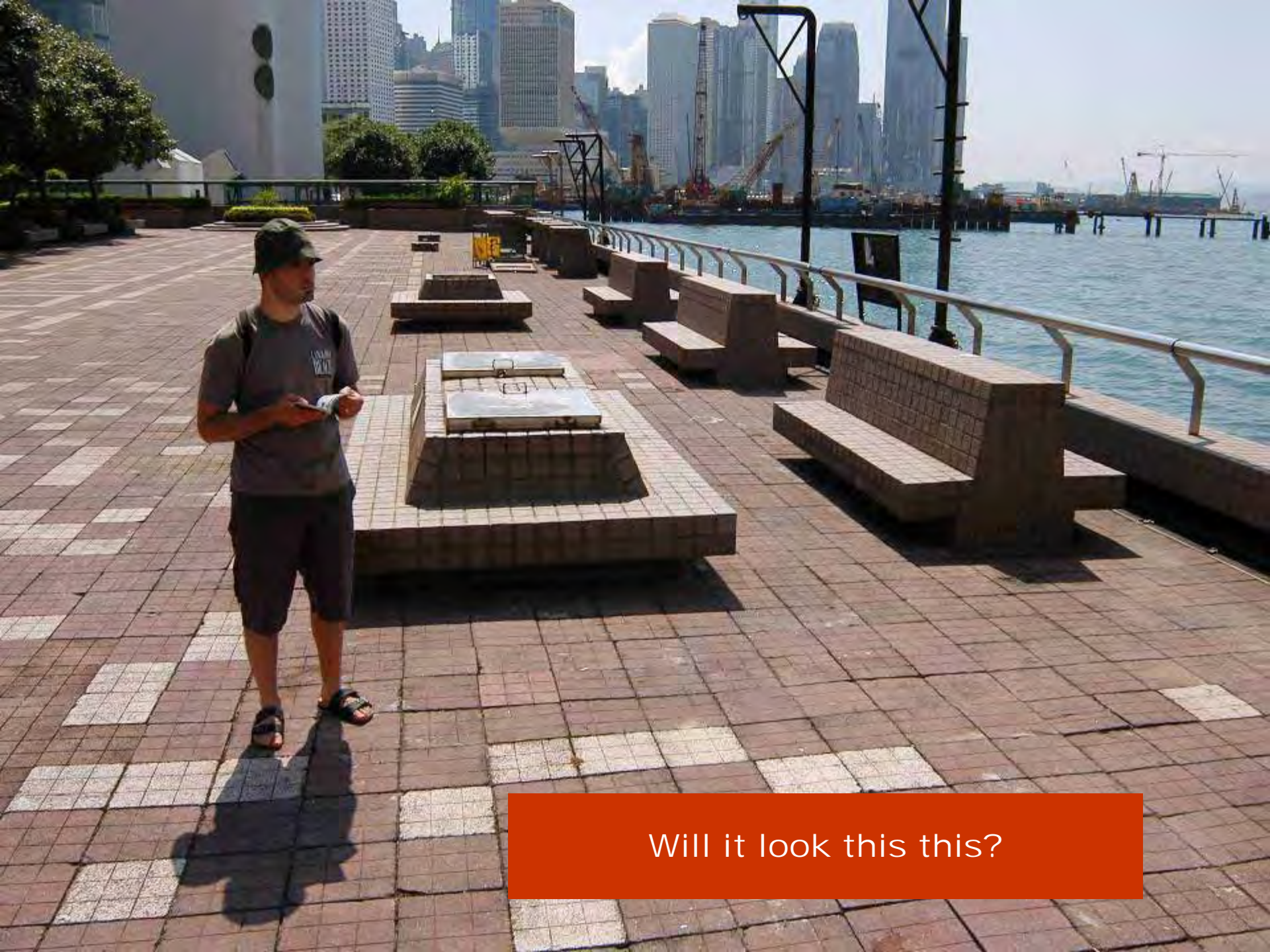

Will it look this this?

Hong Kong's 'best'



Bauhinia Square

Best effort

Worse is yet to come
[give way to vehicles altogether]



Hong Kong's unique counter-World City planning solution

地鐵公司
MTR Corporation

心

THE MTR CORPORATION

gB

←
←





Sheung Wan







No Festival Market and Reduced P2





Groundscraper and Festival Market



No Groundscraper



CENTRAL PARK:

A Better Plan for the New Central Waterfront



Put Tamar to better use
for green-blue areas . . .





Quality public open space . . .

HKCEC
(EXISTING)

MARITIME
MUSEUM

HARBOURFRONT
PROMENADE

AXIAL GARDENS

LOW-RISE /
LOW DENSITY
HUMAN-SCALED
MIXED USE AREAS

GARDENS &
PIAZZAS —
GATHERING
PLACES

NEW PIERS



PERFORMING
ARTS / ARTS
CENTRE
(EXISTING)

CITIC TOWER
(EXISTING)

TAMAR SITE:
NEW GOV'T
OFFICES
MID-RISE
DEVELOPMENT

MILITARY
FACILITY
(EXISTING)

TREE-LINED
BOULEVARD
LINKING HKCEC
WITH IFC

CENTRAL HARBOURFRONT CONCEPT

March 2006

樹蔭大道 Ocean Boulevard

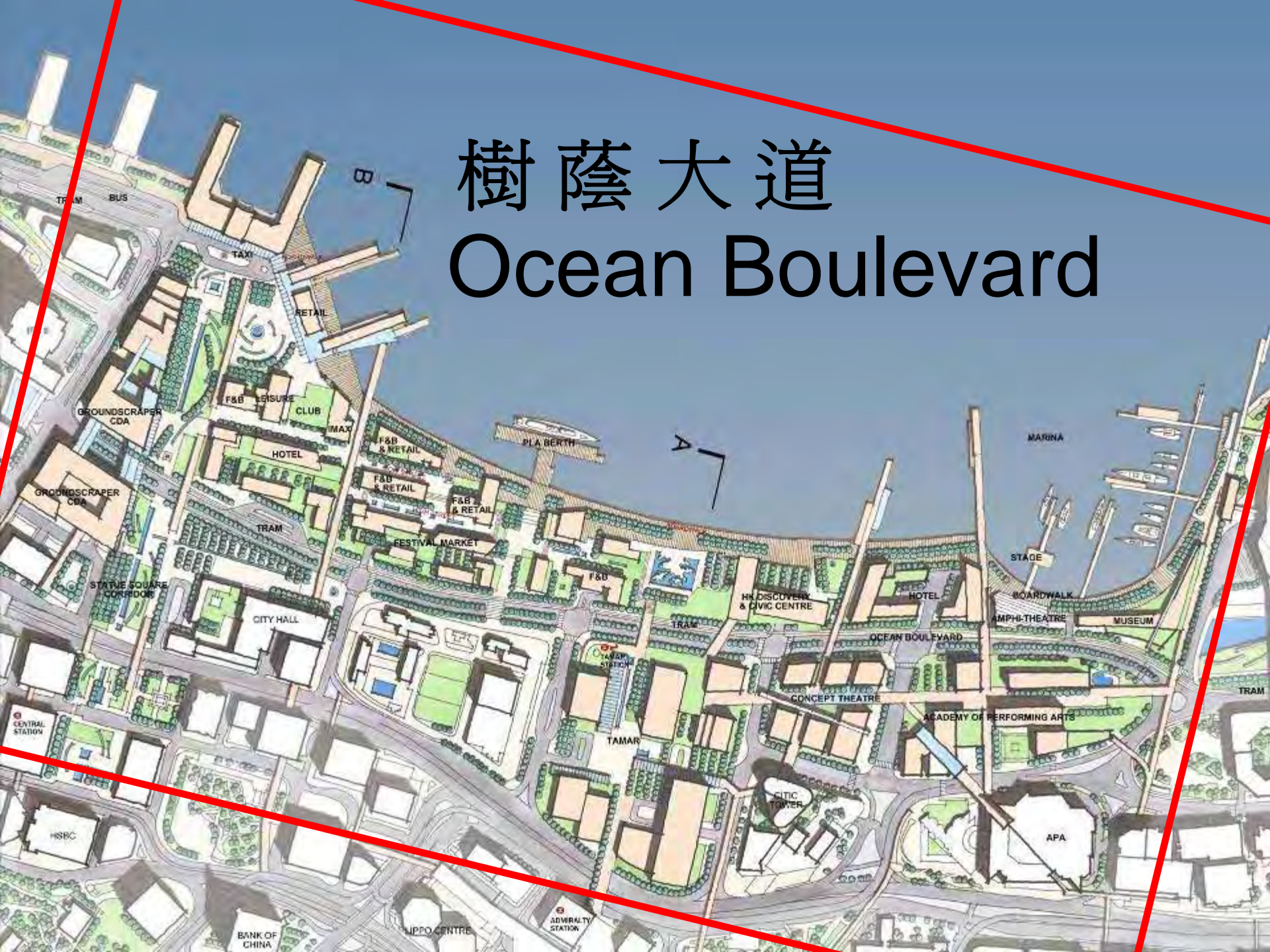

樹蔭大道 Ocean Boulevard

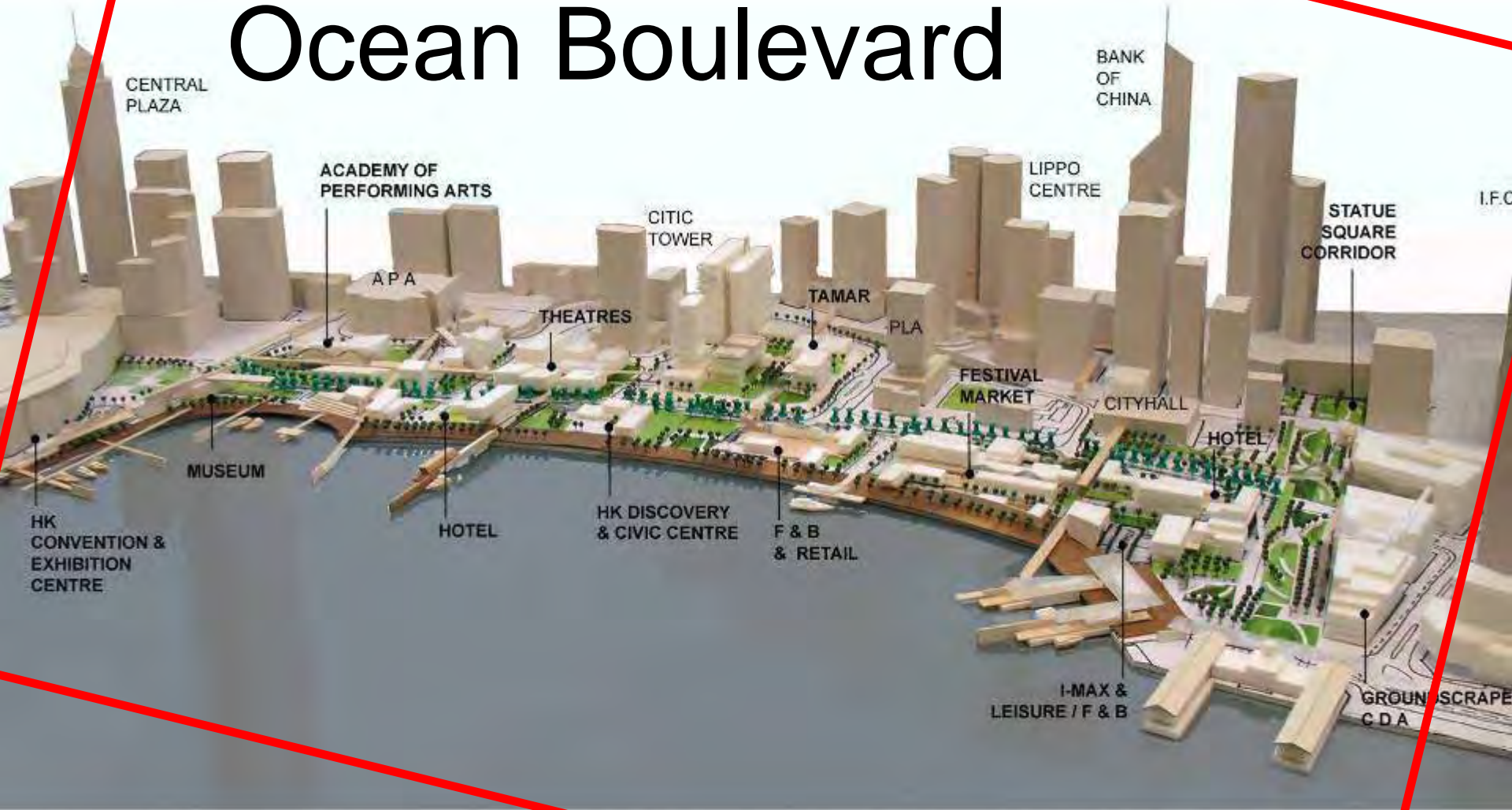

Central Boulevard

中區林蔭大道

