

Hong Kong

May 2006

A CITY BY DESIGN:

RE-INVENTING VANCOUVER'S WATERFRONTS

BY LARRY BEASLEY, C.M.



LOWER MAINLAND



1 THE BIRDS OF THE LOWER MAINLAND

BIRD ALERT

WATERFOWL AND BIRDS OF THE LOWER MAINLAND
 And featured Month Page 12

THE CITY OF VANCOUVER

LOVE AND ORDERS

THE WINE AND SPIRITS INDUSTRY IN VANCOUVER
 and featured Month Page 13



We're Number One (again)

A survey that tallies up quality of life asks Vancouver as one of the best places in the world, but some residents still want banking pay

BY JUDITH KING

It's the second time in two years that Vancouver has topped an international quality of life survey. The city is one of the best places in the world to live.

A survey conducted by the Economist Intelligence Unit, a British-based research organization, ranks the city as one of the best places in the world to live, ahead of cities such as Toronto, London and Sydney.

The survey is conducted annually and is based on 30 indicators of quality of life, including income, health care, education, culture, safety and environment.

The survey also ranked Vancouver as one of the best places in the world to do business, ahead of cities such as New York and London.



Vancouver number one

The city has topped a survey of 100 world cities in two consecutive years. The survey is based on 30 indicators of quality of life, including income, health care, education, culture, safety and environment.

City	Score
Vancouver	92
Toronto	88
London	85
Sydney	82
New York	78
Los Angeles	75
Paris	72
Wellington	70
San Francisco	68

**ECONOMIC
DEVELOPMENT**

=

URBAN DESIGN

SMART CITIES

=

CITIES BY DESIGN



SMART GROWTH

=

SMART BUSINESS

 False Creek North from the South Shore (Charleson Park)

1983



2003



WATERFRONT PLANNING

- **DESIGN CONCEPTS**
 - **PROCESSES**
-



LIVING FIRST STRATEGY







VANCOUVER
NOBLE
DRESSING
ROOMS



DOWNTOWN GROWTH PATTERNS

WITHIN A LAND AREA OF APPROX. 2 SQUARE MILES

1986: 43,000 RESIDENTS

1991: 47,000 RESIDENTS

1996: 62,000 RESIDENTS

2004: 85,000 RESIDENTS

2021: 120,000 RESIDENTS









An aerial photograph of the Greater Vancouver region in British Columbia, Canada. The image shows a mix of urban development, green spaces, and water bodies. A yellow line outlines the entire metropolitan area. A blue line follows the coastline. A green line highlights a specific area of agricultural land in the central part of the region. Text labels are overlaid on the image: 'GREATER VANCOUVER' in the top right and 'agricultural land' in the bottom right.

GREATER VANCOUVER

agricultural land

STANLEY PARK

BURRARD INLET

ENGLISH BAY

THE DOWNTOWN PENINSULA

FALSE CREEK





















































PROVENCE

RESTAURANT



















Welcome to the Neighbourhood!

The present and future shape of Concord Pacific Place



The Concord Pacific Centre

Concord Pacific Centre is a new 15-story office building located at the corner of Burrard and Pacific Streets. The building will provide 1,200,000 sq. ft. of office space, 100,000 sq. ft. of retail space, and 100,000 sq. ft. of parking space. The building is expected to be completed in 2005.



First Centre for the Performing Arts

The First Centre for the Performing Arts is a new 10-story building located at the corner of Burrard and Pacific Streets. The building will provide 1,000,000 sq. ft. of office space, 100,000 sq. ft. of retail space, and 100,000 sq. ft. of parking space. The building is expected to be completed in 2005.



The Station

The Station is a new 10-story building located at the corner of Burrard and Pacific Streets. The building will provide 1,000,000 sq. ft. of office space, 100,000 sq. ft. of retail space, and 100,000 sq. ft. of parking space. The building is expected to be completed in 2005.



The Renaissance

The Renaissance is a new 10-story building located at the corner of Burrard and Pacific Streets. The building will provide 1,000,000 sq. ft. of office space, 100,000 sq. ft. of retail space, and 100,000 sq. ft. of parking space. The building is expected to be completed in 2005.



Greater Vancouver

Greater Vancouver is a new 10-story building located at the corner of Burrard and Pacific Streets. The building will provide 1,000,000 sq. ft. of office space, 100,000 sq. ft. of retail space, and 100,000 sq. ft. of parking space. The building is expected to be completed in 2005.



Downtown Place

Downtown Place is a new 10-story building located at the corner of Burrard and Pacific Streets. The building will provide 1,000,000 sq. ft. of office space, 100,000 sq. ft. of retail space, and 100,000 sq. ft. of parking space. The building is expected to be completed in 2005.



Greater Metro Area

Greater Metro Area is a new 10-story building located at the corner of Burrard and Pacific Streets. The building will provide 1,000,000 sq. ft. of office space, 100,000 sq. ft. of retail space, and 100,000 sq. ft. of parking space. The building is expected to be completed in 2005.



Where Vancouver is Going

COMMUNITY CRIME PREVENTION OFFICE

GRAND OPENING 1. TO 3. PM.





URBAN
FARE

RIES

COFFEE BAR

RESTAURANT

177





PREGO COFFEE
ICE CREAM

ATM

PREGO CAFFE
PREGO COFFEE
PREGO ICE CREAM
PREGO PASTA
PREGO PIZZA
PREGO SANDWICHES
PREGO SALADS
PREGO SMOOTHIES
PREGO BREADS
PREGO PASTRIES

PUBLIC GOODS REQUIREMENTS

C I T Y O F V A N C O U V E R

parks

schools

daycares

public art

library facilities

community centres

walkways & bikeways















ERROY ELEMENTARY SCHOOL

150

150



NEW SCHOOL



ARTWORKS

937 East Fourth Avenue

STUDIO
&
SALE



























ACOUSTIC STANDARDS

CITY OF VANCOUVER HEALTH

ROOMS OR AREA:

bedrooms	40 DBA/24 hours
living + dining	45 DBA/24 hours
outdoor amenity space	60 DBA/24 hours

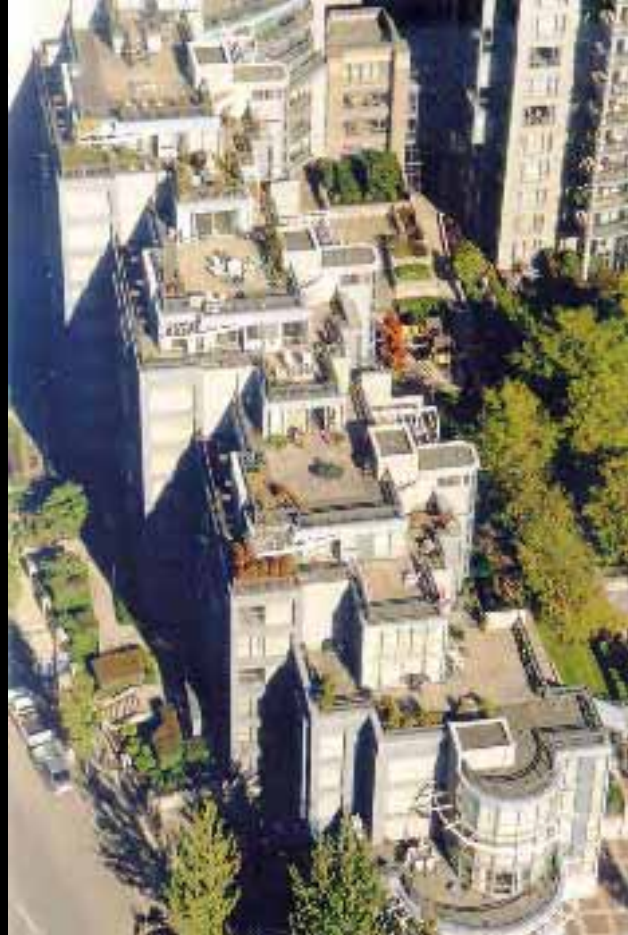







































A modern building with a large waterfall feature. The waterfall is a wide, shallow cascade of water over a dark, textured ledge. The building has large glass windows and a balcony with a metal railing. The scene is set outdoors with trees and a clear blue sky in the background.

the sipping edge of the heaving sea



















VIEW CONES

- A Alder Terrace to Mt. Cassin
- B Charleston Cannon Dr. to Lewis & Concord Streets
- C Liberty Lane to High St. to Lewis & Concord Streets
- D Heather Way to Mt. Cassin
- E Cornelia Bridge to Dover, Cassin & Mt. Cassin
- F Green P. Lincoln Park to North Dover Hill (incl.)
- G Capitol & 1/2 to the North End
- H County Hill to Mt. Cassin
- I Gateway to Freedom to Capitol Hill & Mt. Cassin
- J Greenfield & Broadway to Mt. Cassin
- K Mt. Cassin to Mt. Cassin

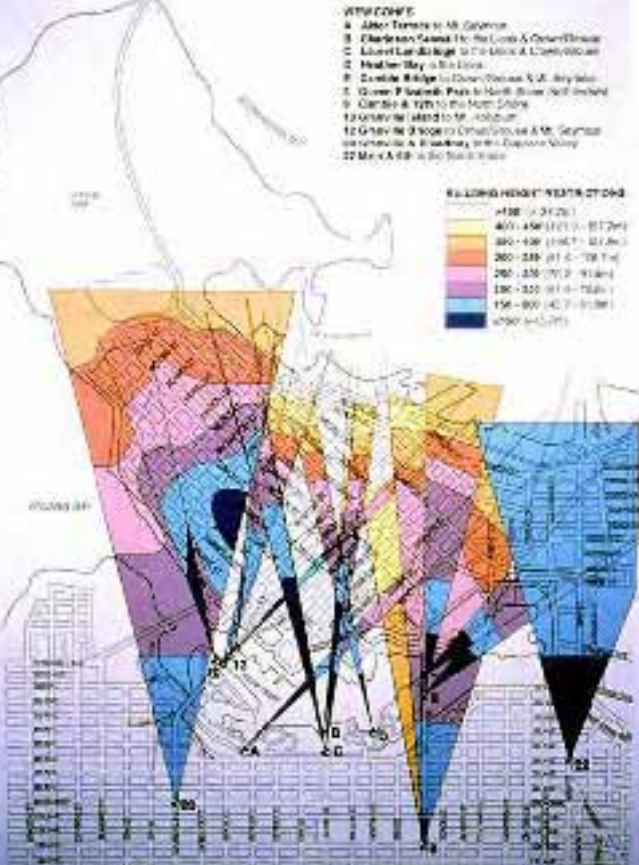
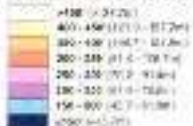
BUILDING HEIGHT RESTRICTIONS

VIEW CONES OVER THE DOWNTOWN
AND RESULTING BUILDING HEIGHT RESTRICTIONS
City of Manhattan Planning Department

Scale: 1" = 100'

City of Manhattan

Scale



Required view corridors

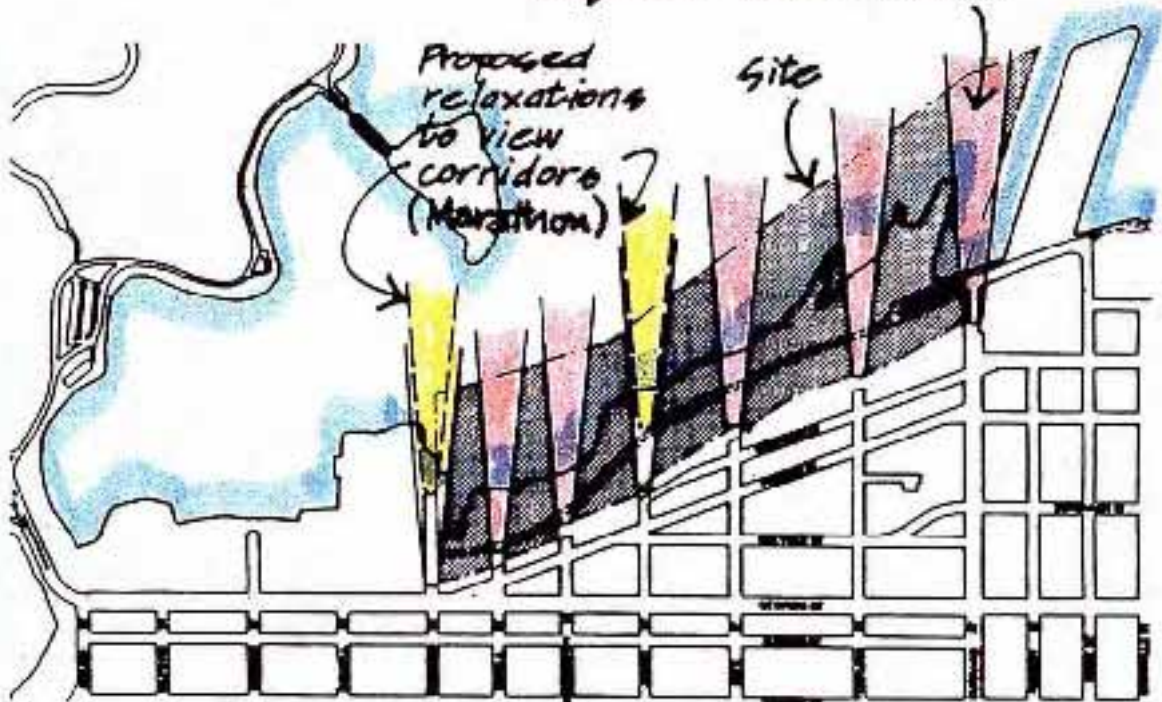

STREET-END VIEW CORRIDORS

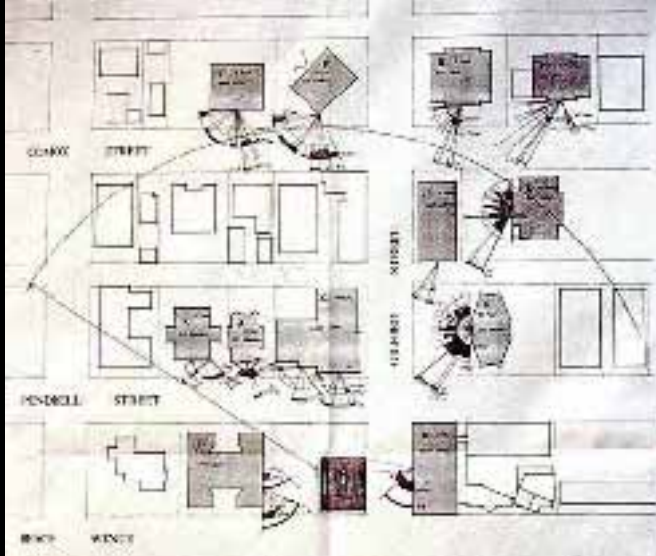

NEW WORK PROPOSED TO DEVELOP SCHEM B

NO.	AREA	AREA	AREA
1
2
3
4
5
6
7
8
9
10
11
12
13
14
15
16
17
18
19
20
21
22
23
24
25
26
27
28
29
30
31
32
33
34
35
36
37
38
39
40
41
42
43
44
45
46
47
48
49
50
51
52
53
54
55
56
57
58
59
60
61
62
63
64
65
66
67
68
69
70
71
72
73
74
75
76
77
78
79
80
81
82
83
84
85
86
87
88
89
90
91
92
93
94
95
96
97
98
99
100

PLAN



ELEVATION

**THE HUNTINGTON
VIEWS STUDY**

SMITHE ST.

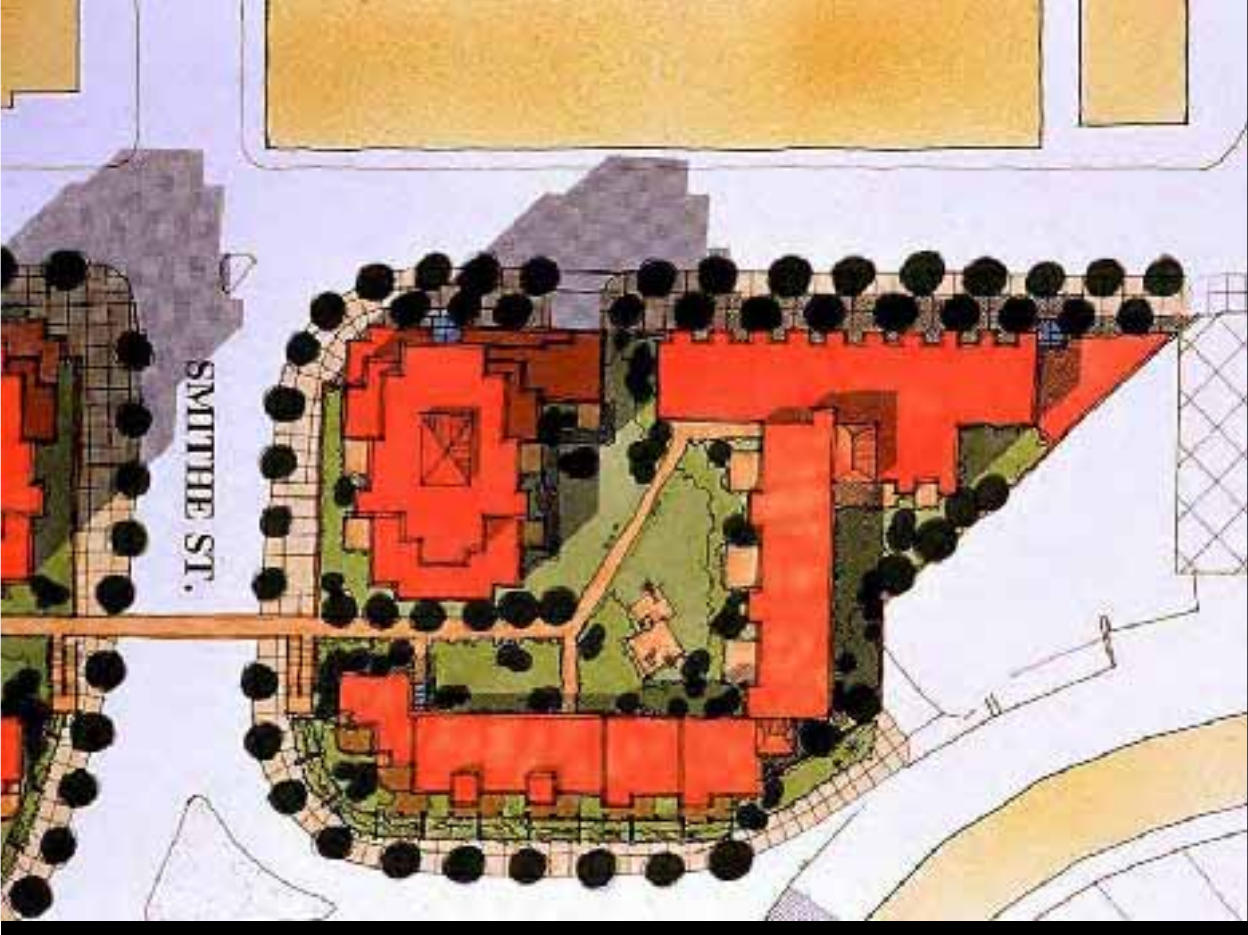















A photograph of a man standing on a high, dark stone ledge. A waterfall flows down the center of the ledge. A dark sign with white text is mounted on the stone. The background shows a modern building with glass windows.

*in the
air of
sun and
wind
the
feeling
of
lightness
on the
stealing
edge
of the
beating
heart*











EXCITING
LIVING



DOWN TOWN



261-6162/6895756

CONCORD PACIFIC PLACE

Living!

Vancouver's
new waterfront
lifestyle
April No. 3



Vancouver's
Most Celebrated
Scene



The Flavour of Yaletown
Highlights of the
Neighbourhood
Community
Update



Mayor: No one should ever have to live on the street

BY LARRY CAMPBELL

Four British Columbia cities will soon be judged for their progress in the fight against homelessness in a survey by the Okanagan Mirror. The target is to reduce the number of people living on the streets by 50 per cent in a matter of two to three years.

The cities chosen are Kelowna, Kootenay, Penticton and Vernon. The survey will be conducted in 2005. The cities are being ranked on the basis of their progress in the fight against homelessness.



...the ...
...the ...
...the ...
...the ...

THE FRONT

Crystal meth's the drug of choice

Crystal methamphetamine has become the drug of choice for many addicts in the Okanagan Valley, according to a report by the Okanagan Mirror. The report says that the drug is being sold in large quantities and is being used by a growing number of people. The report also says that the drug is being sold in a variety of forms, including pills, powder, and crystals. The report says that the drug is being sold in a variety of locations, including street corners, parking lots, and public places. The report says that the drug is being sold in a variety of ways, including through dealers, friends, and family members. The report says that the drug is being sold in a variety of quantities, from small amounts to large quantities. The report says that the drug is being sold in a variety of prices, from a few dollars to hundreds of dollars. The report says that the drug is being sold in a variety of ways, including through dealers, friends, and family members. The report says that the drug is being sold in a variety of quantities, from small amounts to large quantities. The report says that the drug is being sold in a variety of prices, from a few dollars to hundreds of dollars.



Dealers, addicts just move around

Downtown Eastside problems appear elsewhere as police crack down on drugs

BY FRANKIE BULL
AND PETER JONES

...the ...
...the ...
...the ...
...the ...





ARCHITORTURE

Dack's
SHOES















CO-OPERATIVE PLANNING



Public/Private

The Mayor



The Community

- DISCRETIONARY REGULATORY FRAMEWORK

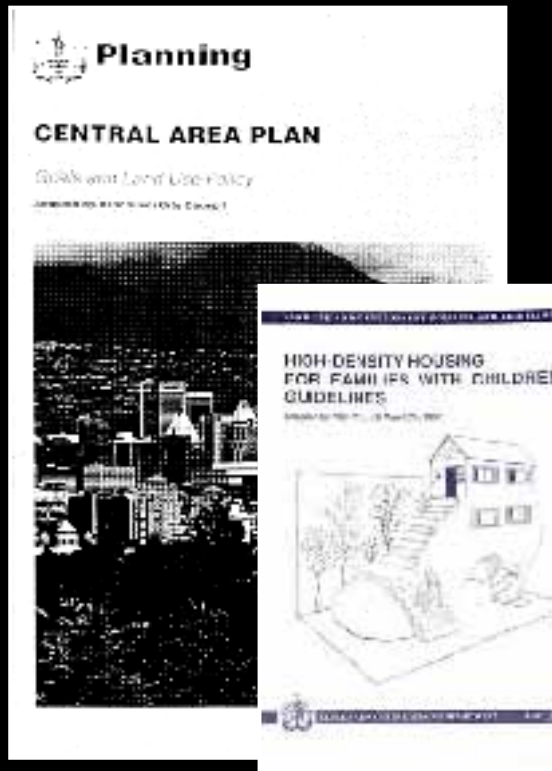



NON-POLITICAL DECISION-MAKING AND VERY
PRESCRIBED APPEAL





PROACTIVE PLANNING



SERVICE-ORIENTED BUREAUCRACY

GENERAL TO SPECIFIC IN STAGES

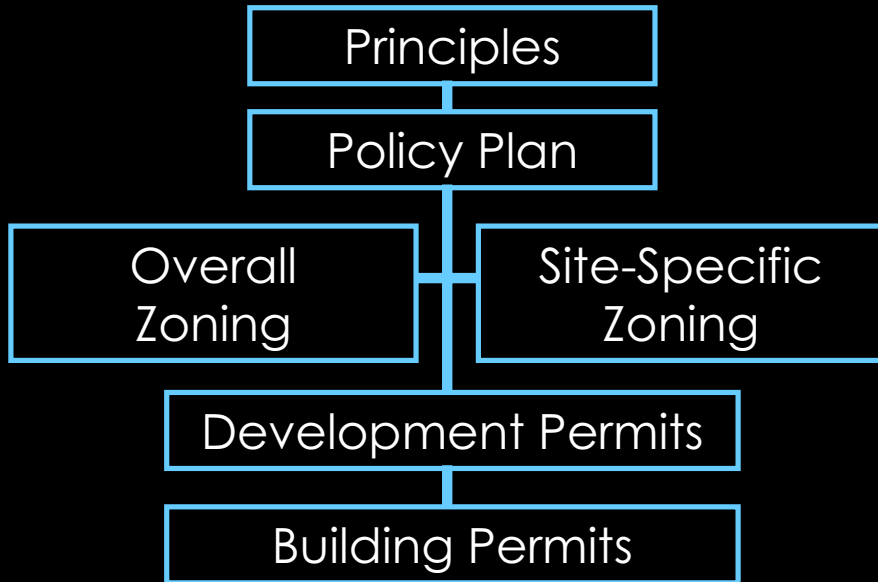







- JOINT DESIGN EXERCISES



DEVELOPMENT ECONOMICS LITERACY



NEW STANDARDS



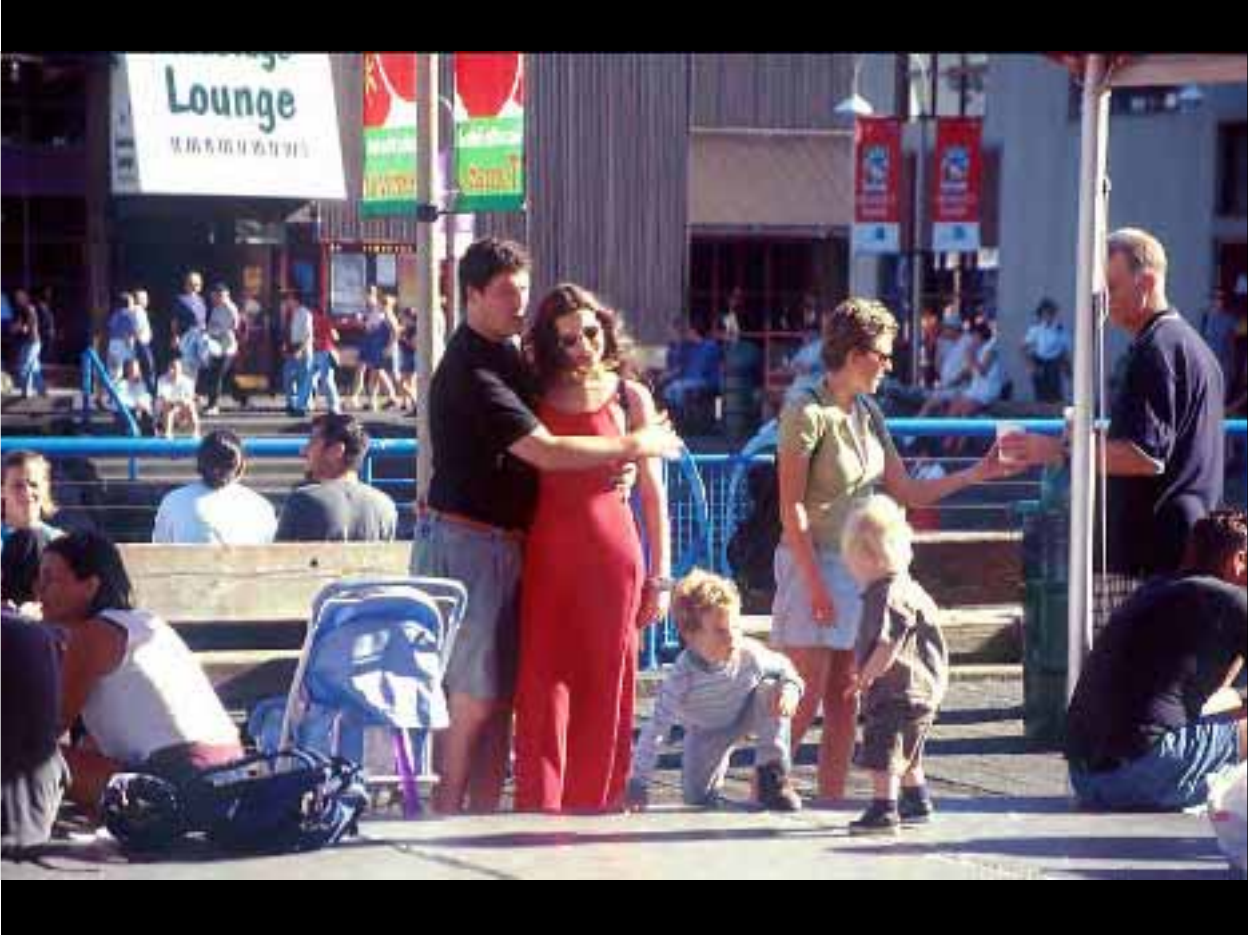





False Creek North from the Granville Bridge

1983



2003



